

REV 00
DATE: OCT 13, 2018

Avid Controls Inc.
41261 Park 290 Drive, Waller, TX 77484, USA
info@avidcontrolsinc.com
(+1) (281) 640-8600

AVID Controls Inc. pursues a policy of continuous product improvement and innovation. This may not be the latest revision of this publication and may not reflect all current product changes. Contact AVID Controls Inc. for the latest revision of this data sheet and information on other product enhancements.

- The MVC3002-4001-A is manufactured by Avid Controls Inc. of Waller, Texas, USA under license from the General Electric Company.
- The MV3000 DELTA I/O PANEL is used to interface plant signals to and from the MV3000 CDC controller.
- The I/O panel is designed to be mounted close to the CDC controller as per instructions on the back page of this guide.

Contents of MVC3002 DELTA I/O PANEL

This kit contains:

- MVC3002-4001-A MV3000 DELTA I/O PANEL
- 50 Way Ribbon Cable
- 50 Way Ribbon Cable clamp and base
- This Data Sheet
- Sheet T1976 DNV-GL Compliance

For correct installation, operation and use, please refer to the following technical manuals available via Avid Controls:

- T1689, Technical Manual for MV3000 Air Cooled DELTA Drive Systems
- T1693, Technical Manual for MV3000 Liquid Cooled DELTA Drive Systems

Disposal

This equipment or any part of the equipment should be disposed of in accordance with the laws of the country of use.

Modern high technology materials have been used in the manufacture of the equipment to ensure optimum performance. Care has been taken with the selection of these materials to minimize risks to health and safety. However, some materials require special consideration during the disposal.

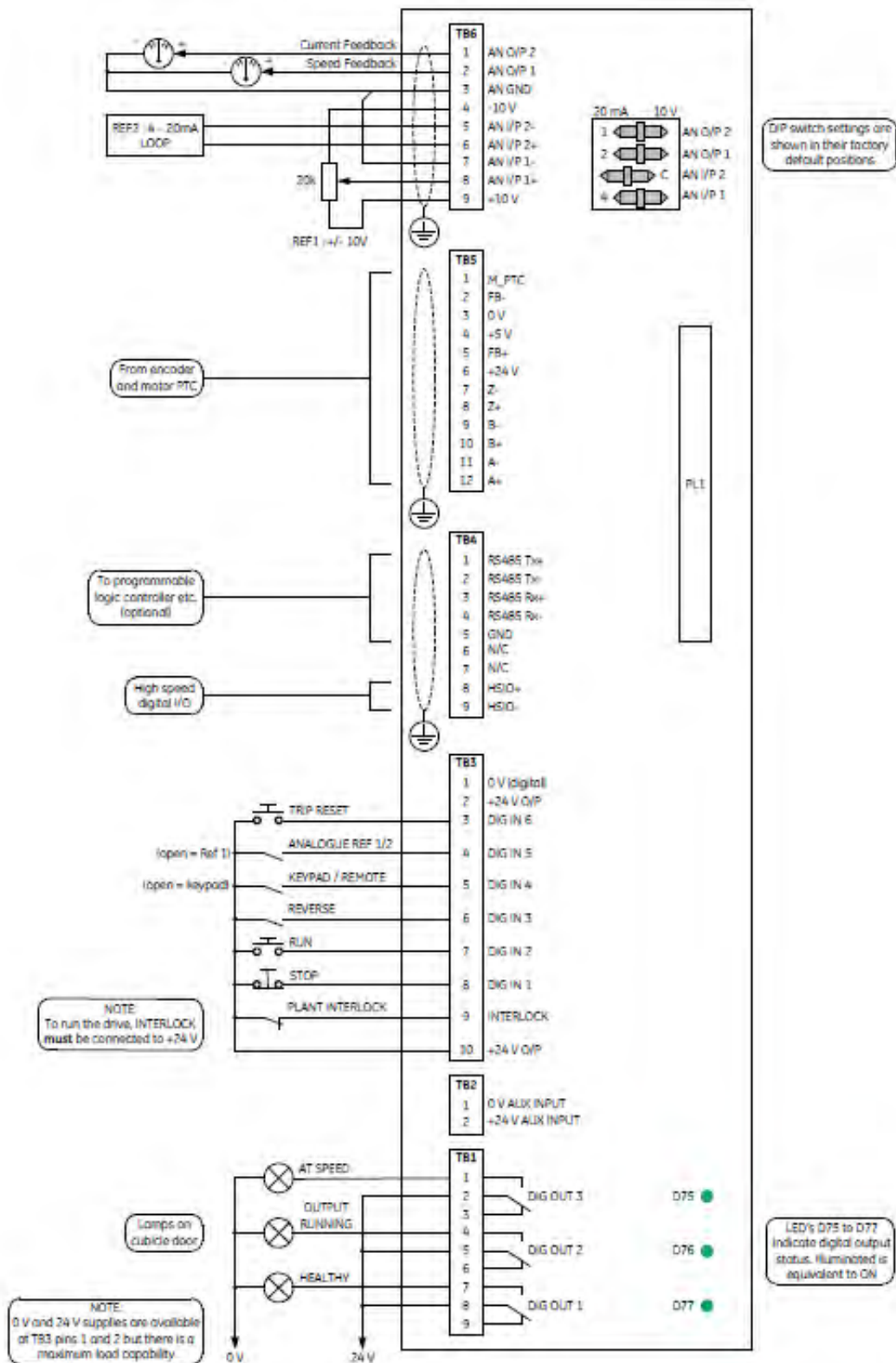

General Arrangement and Functions of the MV3000 DELTA I/O Panel

Layout and Connections for MV3000 I/O Panel

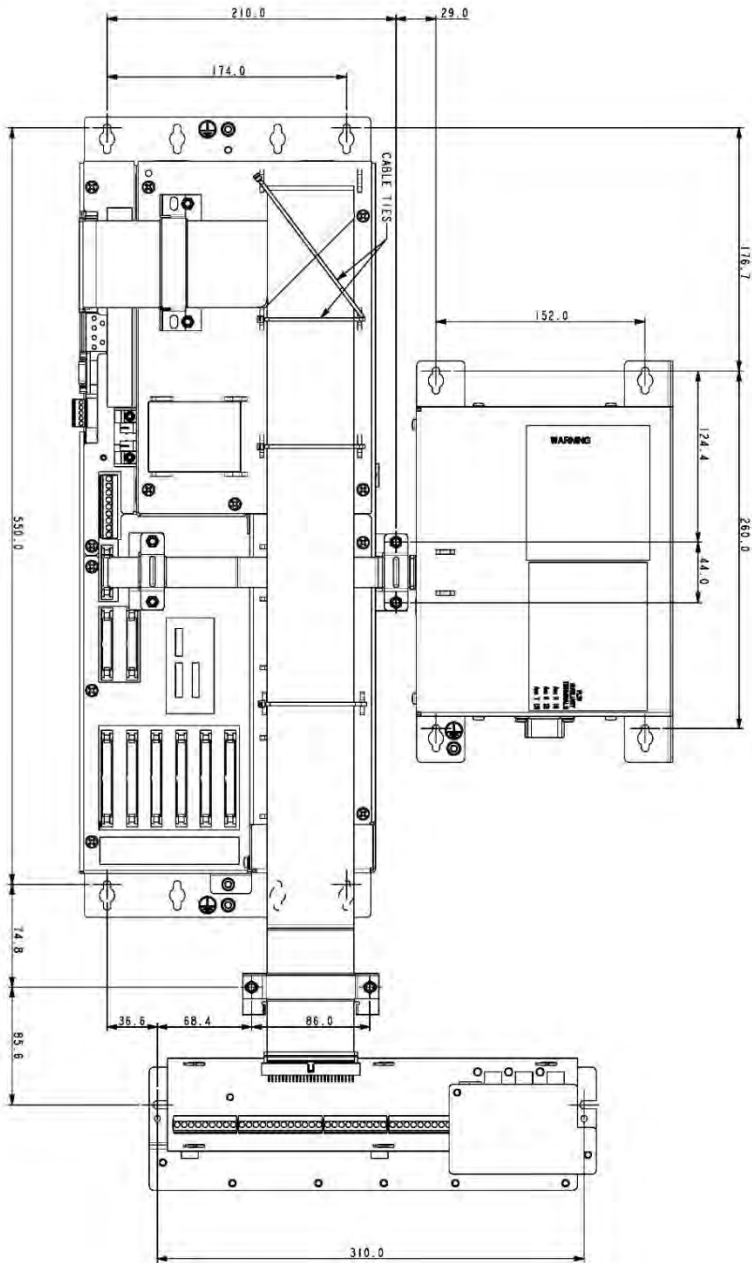

NOTES:

- 1) UNITS TO BE SECURED USING M3 TAPTITE SCREWS SUPPLIED OR LOCALLY SOURCED M3 OR NG 1.0 SCREWS.
- 2) ROUTING HOLES TO BE DRILLED Ø4.5mm FOR SUPPLIED M3 TAPTITE SCREWS.
- 3) ROUTE RIBBON CABLES AS SHOWN. SECURE WITH CABLE TIES.
- 4) ENSURE THAT ONLY THE EXPOSED SCREW OF THE RIBBON IS CLAMPED.
- 5) SEE RELEVANT INSTRUCTION SHEET FOR FULL INSTALLATION DETAILS.

Contact Details for Sales, Service and Support

- Please refer to your local technical support center if you have any queries about this product.

Avid Controls Inc.
 41261 Park 290 Drive, Waller, TX 77484, USA
 info@avidcontrolsinc.com
 (+1) (281) 640-8600

Rev.	Date	Author	Changes
00	Oct 13, 2018	Mark Woods	Original Issue